

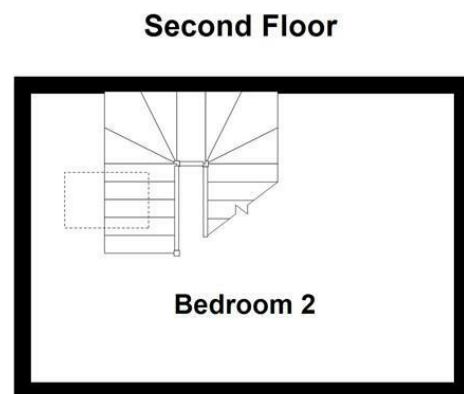

Charles Louis Homes Ltd
4 Bolton Street
Ramsbottom
Bury
BL0 9HX

CHARLES LOUIS
HOMES LIMITED

E propertyenquiries@charleslouis.co.uk
T 0161 959 0166
www.charleslouishomes.co.uk

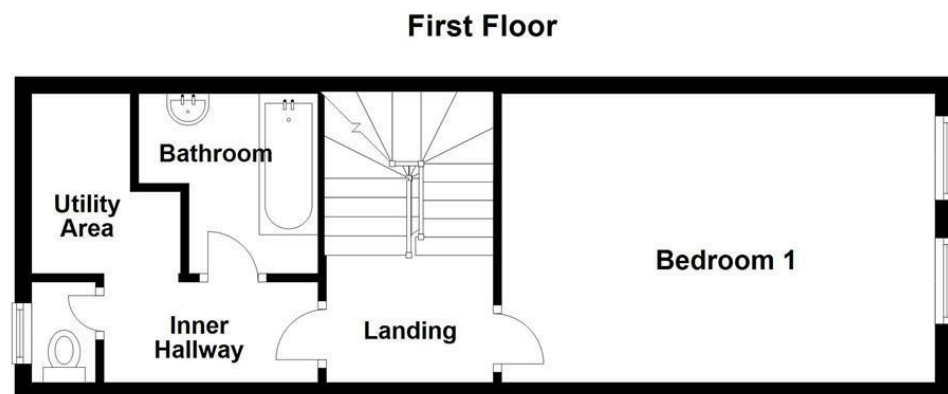
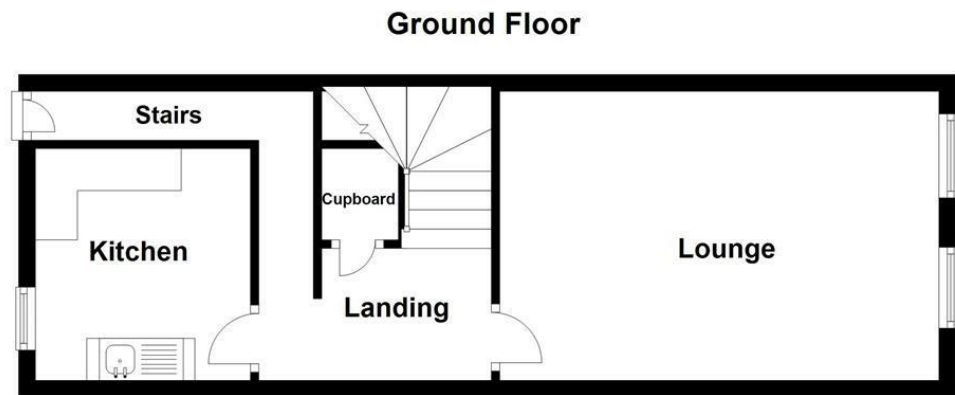

Directions

Energy Efficiency Rating		Environmental Impact (CO ₂) Rating	
Current	Potential	Current	Potential
	74		
	40		
<small>Very energy efficient - lower running costs</small> <small>(92 plus) A</small> <small>(81-91) B</small> <small>(69-80) C</small> <small>(55-68) D</small> <small>(39-54) E</small> <small>(21-38) F</small> <small>(1-20) G</small> <small>Not energy efficient - higher running costs</small>		<small>Very environmentally friendly - lower CO₂ emissions</small> <small>(81-91) A</small> <small>(69-80) B</small> <small>(55-68) C</small> <small>(39-54) D</small> <small>(21-38) E</small> <small>(1-20) F</small> <small>Not environmentally friendly - higher CO₂ emissions</small> <small>(1-20) G</small>	
<small>EU Directive 2002/91/EC</small> <small>England & Wales</small>		<small>EU Directive 2002/91/EC</small> <small>England & Wales</small>	

No 54a Bridge Street
Ramsbottom, Bury, BL0 9AQ

£695 Per month



- Spacious Apartment Over Three Floors
- Situated In The Heart of Ramsbottom
- Secure Entrance at Ground Level
- Two Bedrooms, Bathroom & Separate WC
- Kitchen & Separate Utility Area
- Unfurnished & Available Mid November
- Available from Mid January 2023

These particulars, whilst believed to be accurate are set out as a general outline only for guidance and do not constitute any part of an offer or contract. Intending purchasers should not rely on them as statements of representation of fact, but must satisfy themselves by inspection or otherwise as to their accuracy. No person in this firm's employment has the authority to make or give any representation or warranty in respect of the property.

Tel: 0161 9590166

www.charleslouishomes.co.uk

No 54a Bridge Street

Ramsbottom, Bury, BL0 9AQ

****SUBSTANTIAL APARTMENT SET OVER THREE FLOORS** SITUATED IN THE VERY HEART OF RAMSBOTTOM TOWN CENTRE** TWO DOUBLE BEDROOMS, BATHROOM & SEPARATE WC** KITCHEN & SEPARATE UTILITY AREA**

Charles Louis are delighted to offer this surprisingly spacious apartment situated in Ramsbottom Town Centre, accessed via Prince Street. With all of Ramsbottom's amenities just a stone's throw away, this apartment benefits from having secure entry gate opening to the ground level access. The property comprises in brief; lounge and kitchen to the first floor, master bedroom, bathroom, WC and utility area to the second floor, and a generous second double bedroom to the third. Viewing is essential to appreciate the apartment's position and size. Call today.

Entrance

Entrance door at ground level opens into the apartment with stairs leading to the first floor accommodation.

First Floor

Lounge

With two windows, coving, radiator, TV point and power points.



Alternate View



Kitchen

With a window, laminate wood effect flooring, radiator and power points, a range of wall and base units with contrasting work surfaces, gas cooker point and space for a fridge.



Second Floor

Master Bedroom

With two windows, radiator and power points.

Inner Passage

Bathroom

Partly panelled with wood effect laminate flooring, panel enclosed bath with centre taps, and hand wash basin with pedestal.



Separate WC

With window, laminate wood effect flooring and low flush WC.



Utility Area

With plumbing for a washing machine.

Third Floor

Bedroom Two

With a velux window, radiator and power points.

Entrance



Secure access

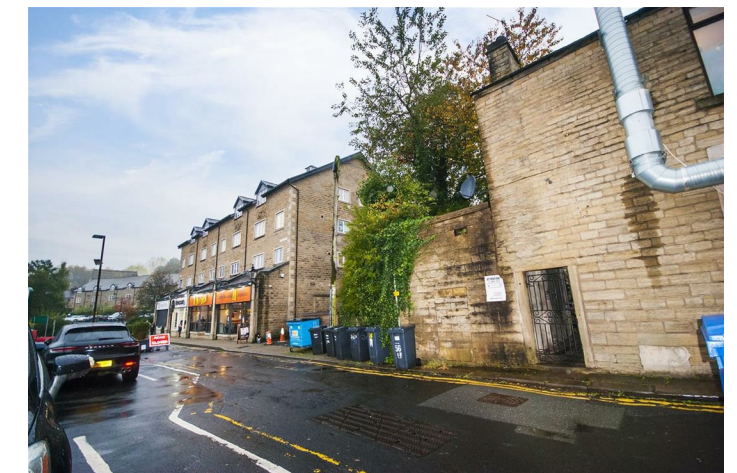

Council Tax Band A